

ILLUSTRATED PARTS LIST

BOLENS
48 INCH CENTER MOUNTED
ROTARY MOWER
ATTACHMENT
MODEL 18048-02

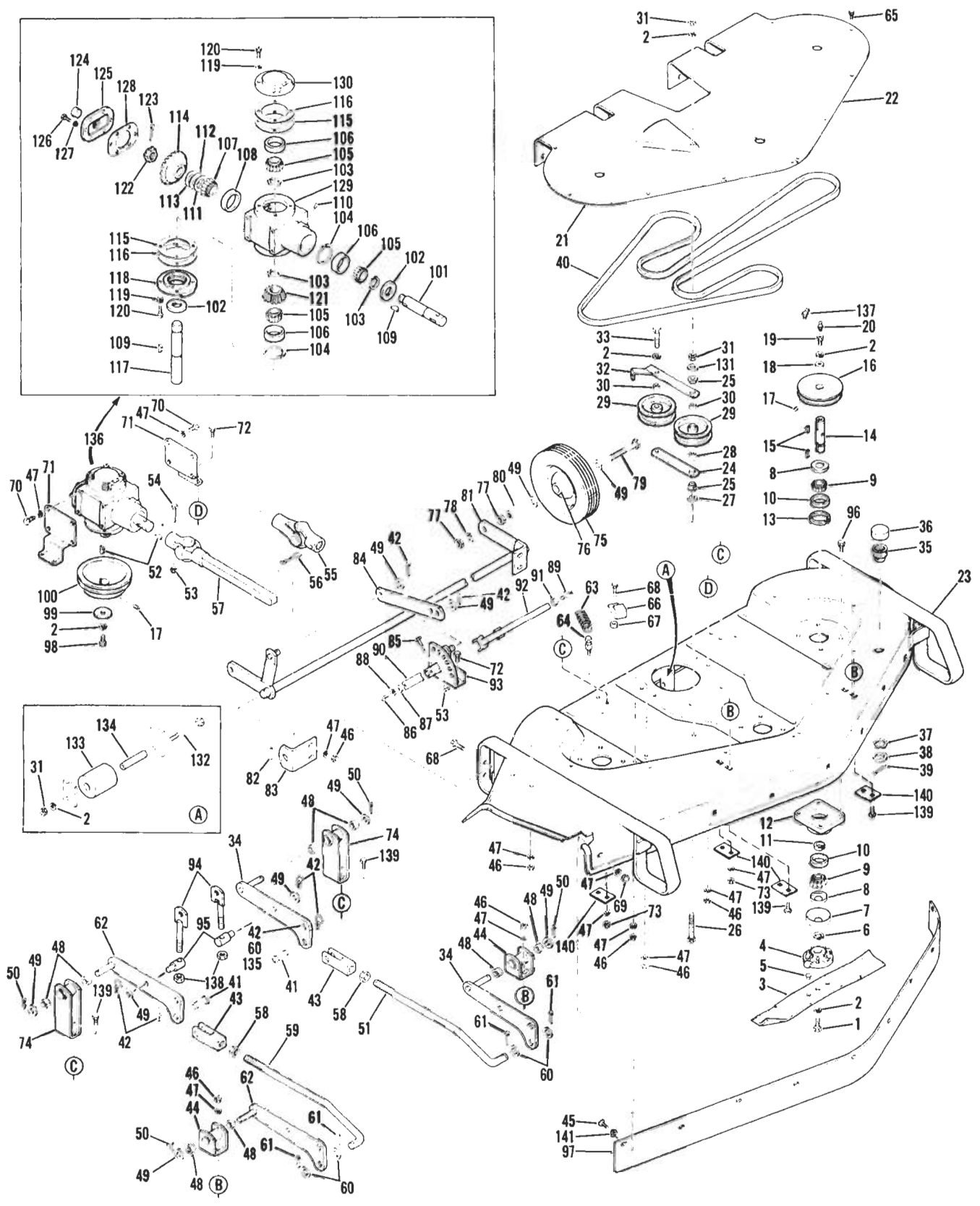

ROTARY MOWER MODEL 18048-02

Ref. No.	Part No.	Description	No. Req'd
1	1100 009	Capscrew, 3/8 - 24 x 1	3
2	1100 243	Lockwasher, 3/8	10
3	1718 638	Cutter Blade	3
4	1719 040	Blade Drive Hub	3
5	1177 330	Rivet	6
6	1185 708	Retaining Ring	3
7	1716 744	Cap	3
8	1185 648	Seal	6
9	1185 275	Bearing Cone	6
10	1185 276	Bearing Cup	6
11	1718 707	Cone Spacer Ring	3
12	1719 330	Bearing Housing	3
13	1718 706	Cup Spacer Ring	3
14	1719 329	Blade Drive Shaft	3
15	1108 852	Square Key, 3/16 x 3/4	6
16	1716 763	Sheave	3
17	1103 466	Set Screw, 5/16 - 18 x 3/8	8
18	1708 755	Flat Washer, 3/8	3
19	1719 331	Bolt	3
20	1104 954	Grease Fitting (use on outer shafts)	2
21	1718 680	Belt Cover, R.H.	1
22	1718 681	Belt Cover, L.H.	1
23	1718 625	Base	1
24	1718 649	Idler Arm	1
25	1714 299	Bushing	2
26	1106 938	Capscrew, 3/8 - 16 x 2-3/4	1
27	1705 092	Washer	1
28	1718 652	Spacer	1
29	1714 742	Idler Pulley	2
30	1718 651	Spacer	2
31	1121 509	Hex Nut, 3/8 - 16	3
32	1718 642	Idler Arm	1
33	1107 249	Capscrew, 3/8 - 24 - 1-3/4	1
34	1718 646	Link Assembly, L.H.	2
35	1719 461	Washout Flange	1
36	1719 467	Protector Cap	1
37	1719 469	Wave Washer	1
38	1703 073	Thrust Washer	1
39	1100 352	Cotter Pin, 1/8 x 1-1/2	1
40	1718 653	Belt - 130 Inches	1
41	1719 324	Clevis Pin	2
42	1703 011	Spring Cotter	10
43	1714 573	End Rod	2
44	1718 675	Bracket	2
45	1111 265	Carriage Bolt, 5/16 - 18 - 3/4	9
46	1182 563	Hex Nut, 5/16 - 18	16
47	1100 242	Lockwasher, 5/16	36
48	1185 509	Sleeve Bearing	8
49	1107 385	Flat Washer, 1/2	12
50	1100 346	Cotter Pin, 3/32 - 3-4	4
51	1718 678	Rod, L.H.	1
52	1100 276	Key, 1/4 x 7/8	2
53	1110 106	Lock Hex Nut, 1/4 - 20	2
54	1106 849	Capscrew, 1/4 - 20 x 1-3/4	1
*55	1718 656	Universal Joint	1
56	1716 369	Cotter Pin	1
*57	1718 657	Universal Joint and Shaft	1
58	1121 513	Hex Nut, 5/8 - 11	2
59	1718 679	Rod, R.H.	1
60	1107 386	Flat Washer, 5/8	8
61	1100 350	Cotter Pin, 1/8 x 1	4
62	1718 645	Link Assembly, R.H.	2
63	1706 822	Extension Spring	1
64	1715 210	Spring Anchor Bolt	1
65	1185 712	Self Threading Screw	16
66	1719 338	Guide	1
67	1718 460	Spacer	1
68	1106 880	Capscrew, 5/16 - 18 x 1-1/8	5
69	1109 939	Acorn Nut, 5/16 - 18	9
70	1106 872	Capscrew, 5/16 - 18 x 5/8	8
71	1718 660	Bracket	2
72	1106 874	Capscrew, 5/16 - 18 x 3/4	6

Ref. No.	Part No.	Description	No. Req'd
73	1110 107	Lock Nut, 5/16 - 18	4
74	1718 672	Bracket	2
75	1719 381	Wheel and Tire Ass'y (Incl. No.76)	2
76	1719 415	Bearing	4
77	1121 511	Hex Nut, 1/2 - 13	4
78	1100 245	Lockwasher, 1/2	2
79	1718 663	Capscrew, 1/2 - 13 x 3-1/2	2
80	1719 397	Bushing	2
81	1718 685	Shaft	1
82	1100 351	Cotter Pin, 1/8 - 1-1/4	1
83	1718 683	Shaft Support	1
84	1718 654	Link	1
85	1106 847	Capscrew, 1/4 - 20 x 1-1/2	1
86	1114 748	Mach Screw, 10 - 32 x 1/2	1
87	1103 959	Flat Washer, #10	1
88	1100 240	Lockwasher, #10	1
89	1185 400	Roll Pin, 5/16 - 1-1/4	1
90	1718 655	Spring	1
91	1719 328	Spacer	1
92	1718 664	Handle Assembly	1
93	1718 667	Quadrant	1
94	1715 404	Link	2
95	1715 401	Stud	2
96	1185 670	Capscrew, 5/16 - 18 x 7/8	12
97	1718 684	Guard	1
98	1111 708	Capscrew, 3/8 - 24 x 5/8	1
99	1703 052	Washer	1
100	1718 659	Sheave	1
101	1718 622	Shaft - Input	1
102	1185 687	Oil Seal	2
103	1185 689	Retaining Ring	3
104	1118 735	Retaining Ring	2
105	1185 661	Bearing Cone	3
106	1185 660	Bearing Cup	3
107	1185 688	Bearing Cone	1
108	1185 118	Bearing Cup	1
109	1709 611	Woodruff Key, 1/4 x 7/8	2
110	182 6*2	Breather	1
111	1800 750	Shim, 1-1/2 x .003	1
112	1800 751	Shim, 1-1/2 x .005	1
113	1800 338	Shim, .015	1
114	1717 459	Gear, 29T	1
115	1717 456	Gasket	10
116	1719 501	Gasket	2
117	1718 621	Shaft - Output	1
118	1717 454	Bearing Retainer	1
119	1100 242	Lockwasher, 5/16	8
120	1185 686	Hex. Hd. Capscrew, 5/16-18 x 3/4	8
121	1717 457	Bevel Pinion, 18T	1
122	1185 662	Slotted Nut, 7/8 - 14 UNF	1
123	1100 352	Cotter Pin, 1/8 x 1-1/2	1
124	1185 685	Plug, 3/4 - 14 NPT	1
125	1717 448	Cover	1
126	1185 684	Hex. Hd. Screw, 1/4 - 20 x 5/8	6
127	1100 241	Lockwasher, 1/4	6
128	1717 449	Gasket Cover	1
129	1719 710	Gear Case (Incl. 107, 108, 111, 112, 113)	1
130	1718 620	Bearing Retainer	1
131	1100 256	Flat Washer, 3/8	1
132	1106 948	Capscrew, 3/8 - 16 x 4	1
133	1717 637	Roller	1
134	1717 968	Spacer	1
135	1713 501	Clevis Pin	4
136	1718 650	Gear Case Ass'y	1
137	1110 086	Grease Fitting 45° (center shaft only)	1
138	1110 110	Slef Lock Nut	2
139	1111 266	Carriage Bolt	8
140	1720 372	Support Plate	4
141	1107 382	Flat Washer	9

* 1714 207 Repair Kit for Joint Marked 6N
 * 1714 208 Repair Kit for Joint Marked NEAPCO



BOLENS

PORT WASHINGTON, WISCONSIN, U.S.A.

PRINTED IN U.S.A.

FORM NO. P-551903 11-67